

Penguins in Peril Manual

1 General Information

2 Save the Penguins!

Way up down at the South Pole, there are few creatures that live amongst the ice and snow. The main inhabitants are the penguins who feed in the frigid ocean waters and live on the ice, huddling together and using their natural fluffiness to keep warm. But also living at the South Pole is a rather unusual creature, a Walrus in fact. It is unusual, in that walruses aren't normally found at the South Pole. He had no idea how he got there, only that he is rather lonely, with no other Walruses to keep him company.



But oh, the poor, misguided fellow, has gotten the wrong idea, and stolen the penguin families' children! And seeing that Walruses aren't used to hauling around penguins all, he's gone and dropped some of them in the middle of nowhere! Now the baby penguins are trapped, stranded, and need help!



Now it's up to Pip, a young explorer to rescue the baby penguins and reunite them with their families before it's too late! Playing as Pip, you must bravely cross the thin ice and other perils to save as many trapped penguins as you can!

3 Controls

This game is played using the buttons. The Touch screen is not used for this game

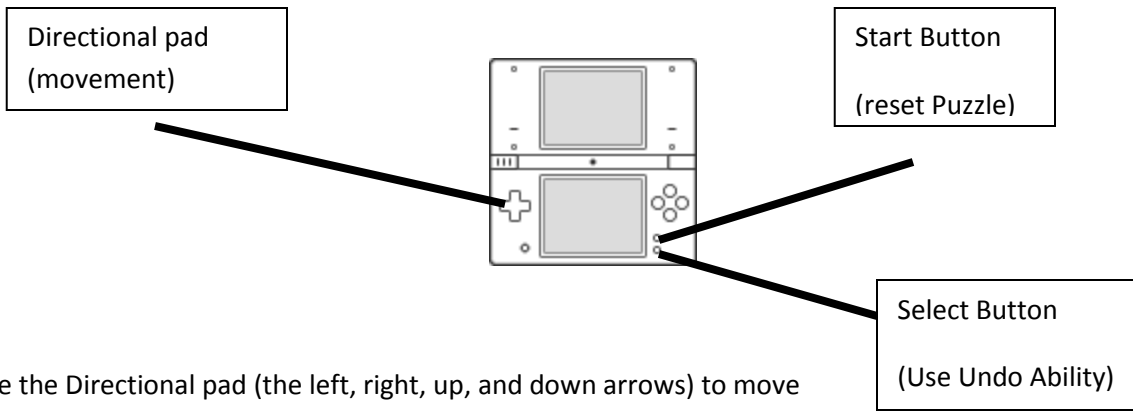

Use the Directional pad (the left, right, up, and down arrows) to move

Start- reset puzzle

Select- Undo ability

4 Getting Started

File Select

From the title screen, choose to start a new game, or continue where you last left off.

Note: The game saves automatically, after each level

5 Gameplay

Each map starts Pip out in a certain location in the level. Levels span both the top and bottom screens. Pip must navigate through the level, collecting as many baby penguins as possible before reaching the wooden arrow sign that marks the level exit. To pick up a penguin, Pip simply needs to walk over a square that has a penguin on it and he will pick the penguin up. Plan your path carefully, as most of the time, as soon as Pip moves over a square of thin ice, that square will melt into water and become no longer traversable!

Pip's goal is to rescue as many penguins as possible before making his way to the wooden arrow sign at the end of every area.



Note: If you get stuck on the ice with no way out, you can use the undo feature to undo mistakes that you've made, a limited number of times. Alternatively, you can also always press the start button to restart the puzzle over again!

Types of Terrain

Across the frozen land, Pip will encounter several different types of terrain, including the following:



Thin Ice: Thin ice may be stepped on once; It melts after Pip moves off it



Thick Ice: Thick ice may be stepped on twice; after being stepped on once, it turns into thin ice



Slippery Ice: Slippery Ice doesn't melt, but when touching it Pip will continue sliding in the direction he was moving, until he hits a barrier. Be careful though! If Pip encounters a water tile while sliding, he'll fall in!



Ground: Ground does not melt, and may be stepped over an unlimited number of times



Rocks: Rocks are impassable boundaries that block Pip's way



Water: when an ice square melts, it turns into water. Water squares are impassable

Types of Penguins

There are several different types of penguins that Pip will encounter, that he will have to rescue from the ice.



Baby Penguin- This is standard stranded penguin. This penguin will stand still and wait for Pip to rescue it.

Playful Penguin- This penguin moves around the map chasing its favorite toy ball.



Shy Penguin- This penguin will run away from Pip as he moves close to it. Pip will have to chase this Penguin down.



Bratty Penguin- This is a very spoiled penguin, and won't agree to be rescued until Pip find's it's favorite thing.



Fatty Penguin-This penguin is very heavy, far too heavy for Pip to pick up. In order to save the fatty penguin, Pip has to push it to the end of the level.

6 Rankings

At the end of each level, you are ranked on your progress. The number of stars you get corresponds to fulfilling certain requirements in the level.

One Star:

Two Stars:

Three Stars:

7 Challenge Mode

After playing through *Penguins in Peril* the first time, you unlock Challenge mode, which allows you to play through any of the *Penguins in Peril* levels with additional penguins to save for added challenge! You can also play any of the levels over again to earn any star ranks you may have missed the first time!